

PRODUCT INFORMATION

END FITTINGS

Lifting points

Lifting points

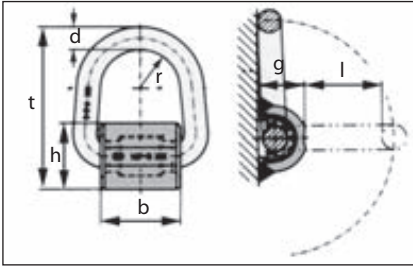

Hold on tight ...
for a firm grip on objects for lifting or transportation.

Lifting point WLP type

Weld-on type

Nominal Size	Working Load Limit (WLL)		Lashing Capacity (LC)	Weight	Measurements							
	vert. 0°	horiz. 90°			b	d	g	h	l	r	t	
	t	t	daN	~ kg/ea	mm	mm	mm	mm	mm	mm	mm	mm
1	1	1	2000	0,5	50	14	27	38	55	24	105	
3	3	3	6000	0,9	58	17	34	48	57	29	120	
5	5	5	10000	1,7	64	22	43	61	74	33	154	

Lashing capacity only for load securement. WLL figures for hoisting operation.

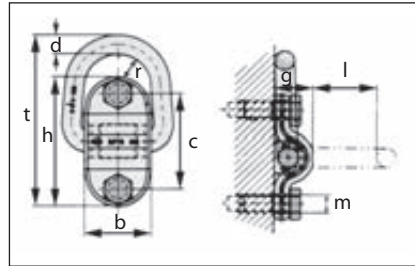

Lifting point SLP type

Bolt-on type

Nominal Size	Working Load Limit (WLL)		Lashing Capacity (LC)	Weight	Measurements									
	vert. 0°	horiz. 90°			b	c	d	g	h	l	m	t	r	
	t	t	daN	~ kg/ea	mm	mm	mm	mm	mm	mm	mm	mm	mm	mm
1	1	1	2000	0,9	50	72	14	27	98	55	14	139	24	
3	3	3	6000	1,4	58	84	17	33	114	58	16	152	29	
5	5	5	10000	2,9	64	116	22	43	160	74	20	203	33	

Lashing capacity only for load securement. WLL figures for hoisting operation.

Hook UKN

Weld-on type

Nominal Size	Working Load Limit (WLL)	Weight	Measurements							
			a	b	c	g	h	k	l	s
	t	~ kg/ea	mm	mm	mm	mm	mm	mm	mm	mm
0,75	0,95	0,3	3	20	56	13	20	19	82	5
1	1,25	0,6	4	21	72	17	25	25	95	6
2	2,5	1,0	5	26	86	20	30	30	114	8
3	3,75	1,3	6	29	105	23	30	35	132	10
4	5	1,9	7	29	111	29	38	42	140	11
5	6	2,8	8	34	130	30	46	45	165	12
8	10	3,7	9	34	133	39	51	50	172	13
10	12,5	6,3	9	47	168	43	58	55	220	14
15	18,5	9,0	10	53	188	52	67	55	240	16



Allrounder



360° rotation and 180° pivot
Compact construction
WLL 25% higher than grade 8
Quick and easy fitting

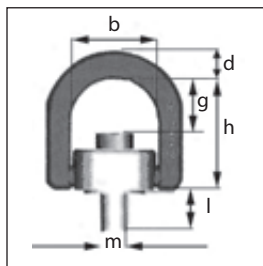

Rotating lifting point RLP type

Grade 10 to screw on

Nominal Size = Thread	Working Load Limit (WLL)		Weight	Measurements				
	vert. 0°	horiz. 90°		b	d	g	h	l
	t	t	~kg	mm	mm	mm	mm	mm
M 8	0,6	0,3	0,3	42	12	35	60	15
M 10	1	0,5	0,3	42	12	34	60	20
M 12	1,5	0,75	0,9	57	19	46,5	85	19
M 16	3	1,5	0,9	57	19	44	85	24
M 20	5	2,5	2,8	83	28	56	111	32
M 24	7	3,5	2,8	83	28	53	111	37

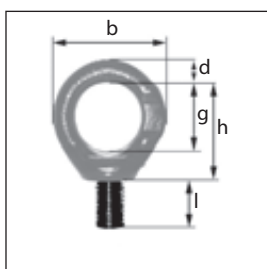

Eye lifting point ELP type

Nominal Size = Thread	Working Load Limit (WLL)		Weight	Measurements				
	vert. 0°	horiz. 90°		b	d	g	h	l
	t	t	~kg	mm	mm	mm	mm	mm
M 16	4	1	0,38	72	16	42	56	24
M 20	6	1,5	0,43	72	16	42	58	30
M 24	8	2	0,85	88	19	48	69	36
M 30	12	3	1,4	106	22	60	84	45
M 36	16	4	2,3	127	26	72	100	54



1t = 1000kg (t = metric ton).

Length of a lifting sling is the usable length when ready for service. It is measured between the bearing points of sling ends/terminations.

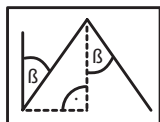

The tilt angle β is the largest angle between legs and vertical line. To determine working load limit of sling operation: Multiply applicable mode factor (see table <Lift methods> below) with the WLL value (single leg direct) from the above table. Adapt the mode factors as appropriate for asymmetrical loads.

Lift methods horizontal:

Single leg	Double leg
straight	straight
90°	90°



WLL determination factors:

1	2
---	---

Lift methods vertical:

Single leg	Double leg		Three- and four-leg		
straight	straight	symmetric	asymm.	symmetric	asymm.
0°	0°	0-45°	45-60°	0-45°	45-60°



WLL determination factors:

1	2	1,4	1	1	2,1	1,5	1
---	---	-----	---	---	-----	-----	---

Lifting points

The whole range ...

Loads up to 30t. Variable thread diameter.
Fourfold safety against breakage in all stress directions.



Swivel lifting point TAWSK

weld-on type
red colour
WLL 2 to 15 t
360° turn, 180° pivot



Lifting point TAPG

bolt-on type
red colour
WLL 3 to 8 t



Lifting point TAPSK

weld-on type
edge attachment
red colour
WLL 3,15 to 8 t



Lifting point TAPS

weld-on type
red colour
WLL 1 to 15t

... and start in the future:

Raised working load limit: 25% more for same dimensions.
Hexagonal swivel body: easier fitting and detachment.
Squeeze marks in ring prevent tilting.

THEIPA® Point



Swivel lifting point TAW

bolt-on type
gold colour
WLL 5 to 15 t
single leg direct
360° turn, 180° pivot
and:

Clearly shows permitted tilt angle.
Jerk-free turning, swivelling and tilting under load.



Roller bearing wear display for end of service life determination without measuring tools.



Machined support for better sit.



This is just a brief presentation of a whole range of products. Details needed? Ask us. We provide all the information you need.

DIN standard ...

drop-forged, normalised, thread to DIN 13, material C15, zinc galvanized, WLL from 0,14t to 38t



Eyebolt
DIN 580



Eyenut
DIN 582

CAUTION!

Functional safety only guaranteed if properly fitted. Fitting instructions on request.