

**PRODUCT INFORMATIONEN**

---

**COMPLEMENTARY EQUIPMENT**

# Connecting devices & lifting gear

---



manufactures:  
hawses, rollers, bollards,  
or equivalent products.  
More on the following pages.

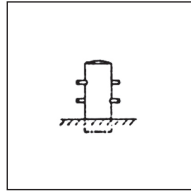

**Steadiness ...**

is no problem with sturdy deck equipment for mooring and towing ships safely and securely.

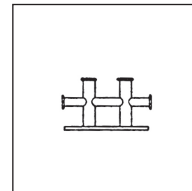
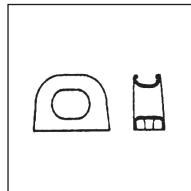
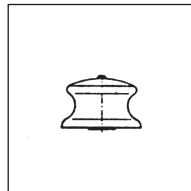
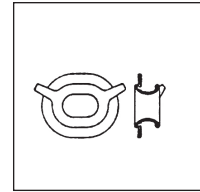
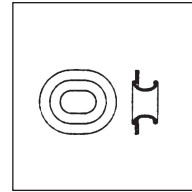
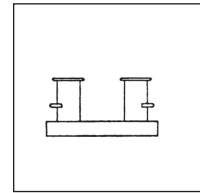

**i MORE...**

This is just a brief presentation of a whole range of products. Details needed? Ask us. We provide all the information you need.

The products presented here are standard industrially produced series products. In certain cases the standard choice may not be suitable. HANSE METALL responds to such needs with fast, flexible solutions: Customised products also in small batches.



**Wrong connection? ...**

Not likely. HANSE METALL supplies the parts to keep things securely connected.

**i MORE...**

This is just a brief presentation of a whole range of products. Details needed? Ask us. We provide all the information you need.

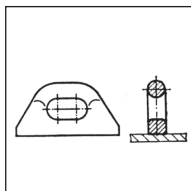
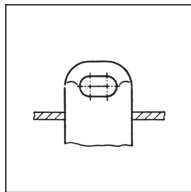

also makes:  
eyeplates with stud or oval eyes, cargo hooks, ramshorn hooks, oval eyes, stud eyes or double lugs with shaft, triangular plates and more ...

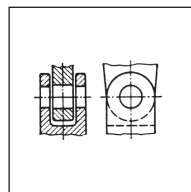
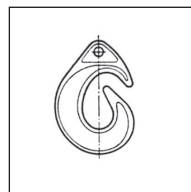
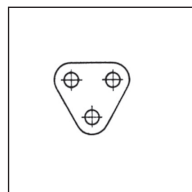
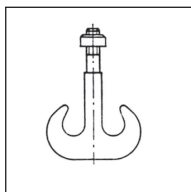
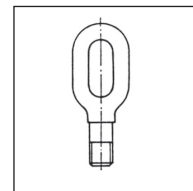
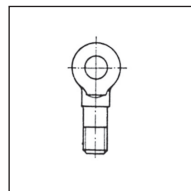
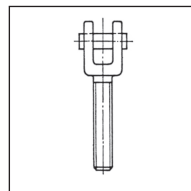
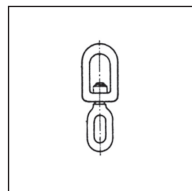
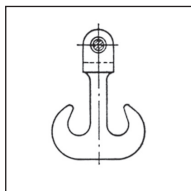
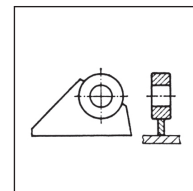

And more ...

## Stud eye plate

DIN 82024

Nom. Size	Perm. Load Capacity (PLC)	Measurements								
		b	d <sub>1</sub>	d <sub>2</sub>	e	h	l	r <sub>1</sub>	s <sub>1</sub>	min. s <sub>2</sub>
	kN	mm	mm	mm	mm	mm	mm	mm	mm	mm
1	10	16	18	-	28	32	85	17,5	-	4
1,6	16	20	22	-	36	40	110	22,5	-	4
2	20	22	24	-	40	44	120	25	-	6
2,5	25	25	26	55	44	48	130	-	8	4
3	32	28	30	60	48	54	145	-	8	4
4	40	30	33	65	52	60	155	-	8	4
5	50	35	39	75	60	72	180	-	10	5
6	63	40	42	85	68	78	200	-	10	5
8	80	45	48	95	76	90	230	-	12	6
10	100	50	52	110	88	96	260	-	14	7
12	125	55	56	120	96	104	290	-	14	7
16	160	60	66	130	104	120	310	-	16	8
20	200	65	74	140	112	136	340	-	20	10

Material: St 37-2, ISO 630

Other sizes on request

For welding instructions please refer to standard

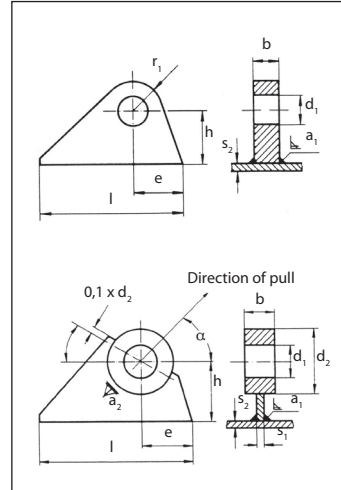

**i MORE...**

This is just a brief presentation of a whole range of products. Details needed? Ask us. We provide all the information you need.

Working Load Limit = 1/4 Breaking Force

## Oval eye plate

ISO 8146 - 1985

Nom. Size	Perm. Load Capacity (PLC)	Measurements					
		a	b	d	e	l	s
	kN	mm	mm	mm	mm	mm	mm
1	10	35	22	16	25	95	6
1,6	16	42	24	20	33	120	7
2	20	50	27	25	35	132	9
2,5	25	55	29	25	39	140	9
3	32	66	33	30	42	180	10
4	40	77	36	35	48	210	12
5	50	87	41	40	57	225	14
6	63	91	45	40	66	240	14
8	80	101	51	50	73	270	17
10	100	117	56	50	80	300	17
12	125	128	61	60	87	335	20
16	160	145	67	60	95	370	20
20	200	157	73	70	105	420	25

Material:

Other sizes on request

Type A for welding on

Type B for welding in

For welding instructions please refer to standard

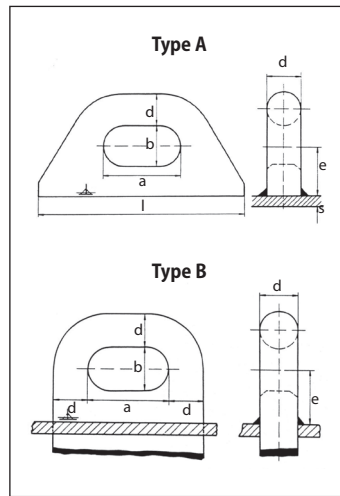

Eye plates, a series product manufactured by our partners HanseMetall, specialists in lifting gear and hoisting equipment, rope guidance and connection technology.

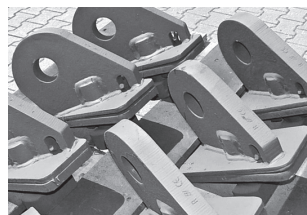

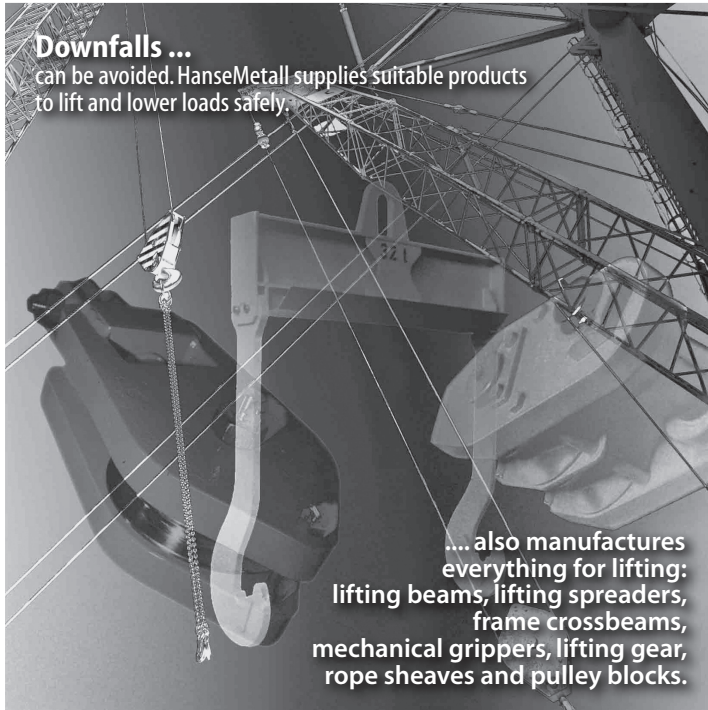

**Downfalls ...**  
can be avoided. HanseMetall supplies suitable products to lift and lower loads safely.

.... also manufactures everything for lifting: lifting beams, lifting spreaders, frame crossbeams, mechanical grippers, lifting gear, rope sheaves and pulley blocks.

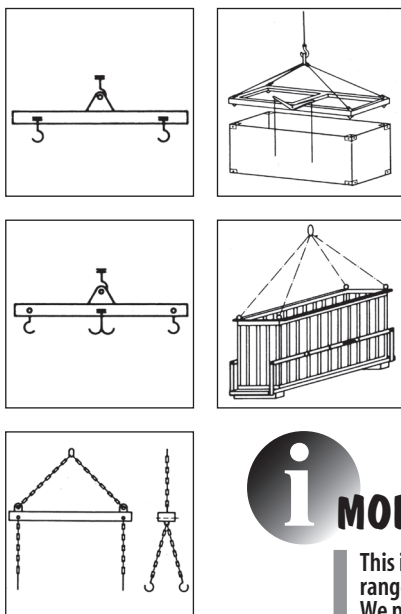
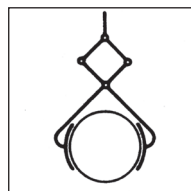
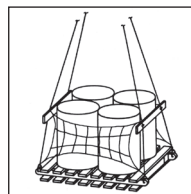
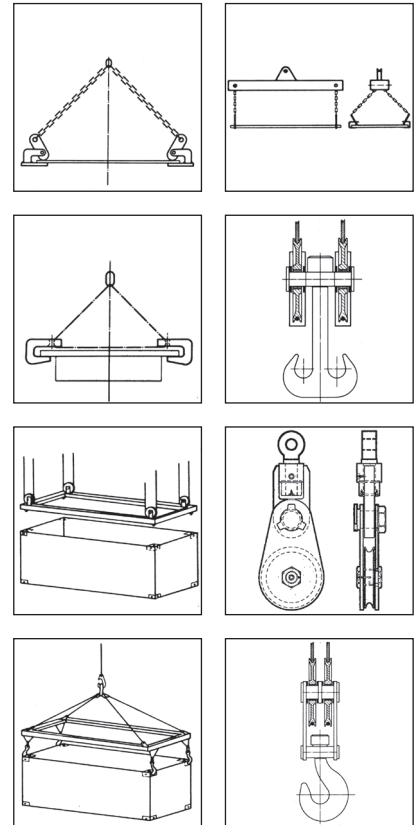

**i MORE...**

This is just a brief presentation of a whole range of products. Details needed? Ask us. We provide all the information you need.

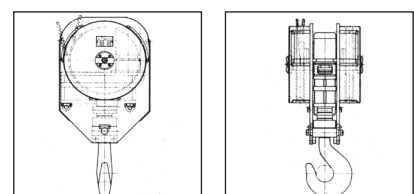

And more ...